

MAKİNA ELEMANLARI TEKNİK RESİMDE GÖSTERİMİ

Altıköşe başlı civata TS 1021/2 M12 x 80– 4.6 C

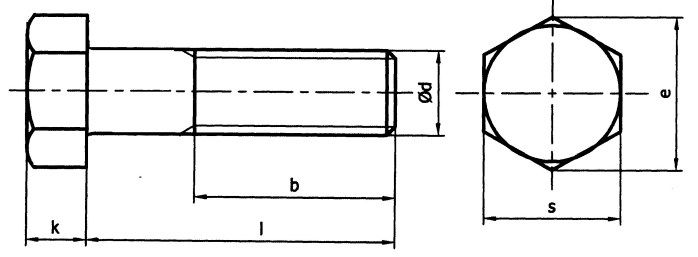

Saplama TS 1025/4 M12 x 80– 8.8

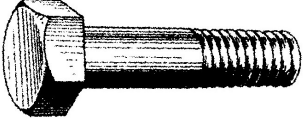
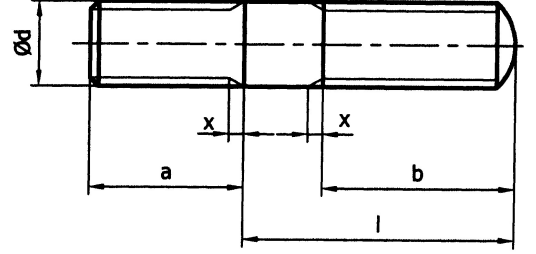

Altıköşe somun TS 1026/1 M12 – 5

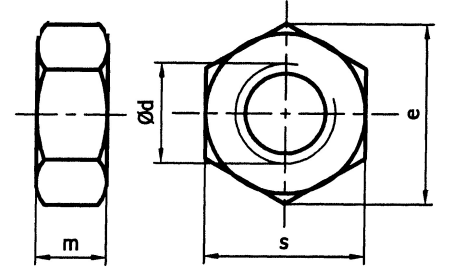
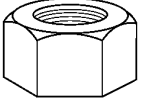

Rondela TS 79/2 A 10.5

Malzeme : Fe 40

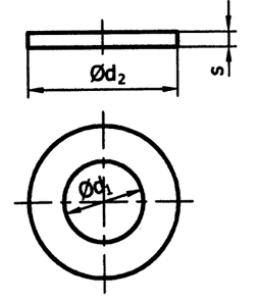
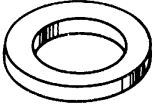

Gupilya TS EN 1234 - 5x15

Malzeme : Fe 42

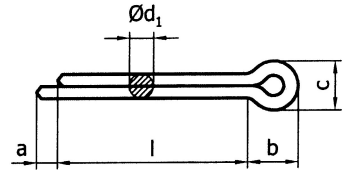

Basınç yayı TS 1440/1 10 x 25 x 38

Malzeme : 67 Si Cr5

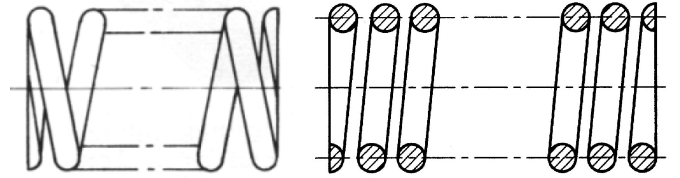

Düz Kama TS 147/1 – 20 x 12 x 125 – A

Malzeme : C45

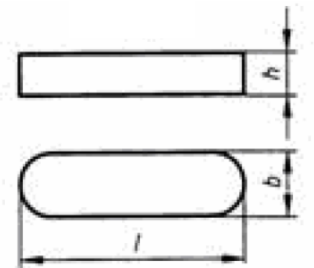
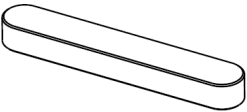

MAKİNA ELEMANLARI TEKNİK RESİMDE GÖSTERİMİ

Kama TS 147/12 - 8 x 11
Malzeme : C45

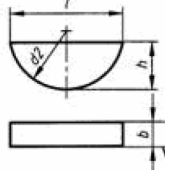
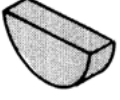

Kamalı mil profili TS 147/15 B 8 x 69 x 14
Malzeme : C45

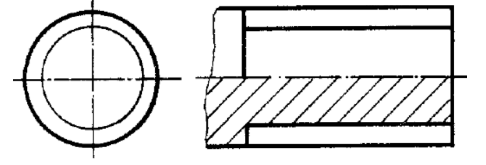
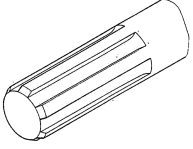

Pim TS 2337/1- 5m6 x20 -A
Malzeme : 9SMnPb28

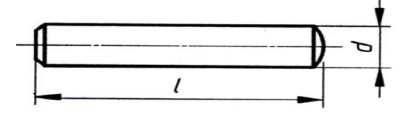

Vidalı pim TS 1024/1 - M12 x 40
Malzeme : Fe50

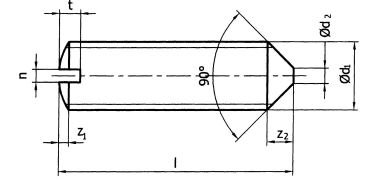

Başsız Perno TS 69/1- A 16 x 50
Malzeme : Fe 50

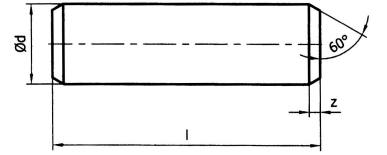

Sabit bilyalı yatak:

6 0 15

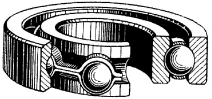

Eksenel bilyalı yatak :

51316

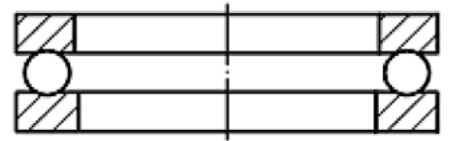
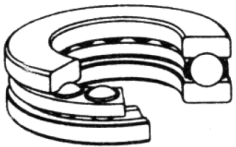

Emniyet segmanı DIN 472 – 25 x 1,25
Malzeme : Ck75

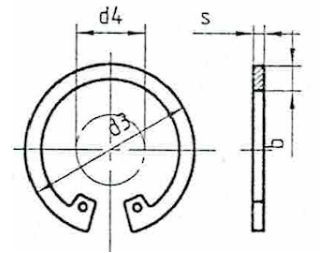

MAKİNA ELEMANLARI TEKNİK RESİMDE GÖSTERİMİ

Emniyet segmanı DIN 471- 30 x 1,5
Malzeme : Ck75

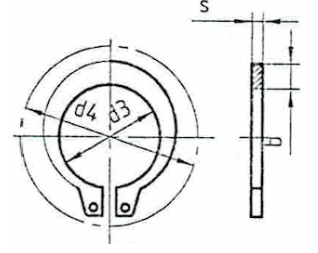

Emniyet rondelası DIN 6799/6
Malzeme : Ck75

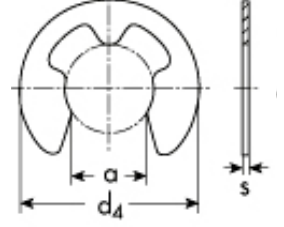
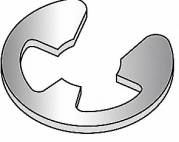

Ayar Bileziği DIN 705 –C 26x40
Malzeme : 9 SMn Pb 28

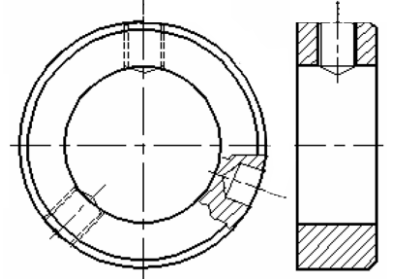

Emniyet somunu DIN 981

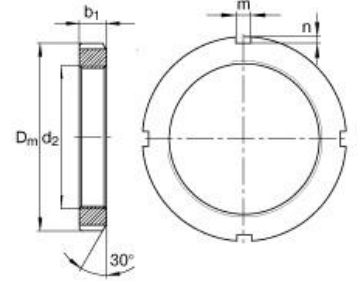
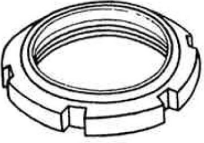

Radyal Keçe TS 868 – A 30x42x7
Malzeme : AC

